

# Serie

# TP

## Carro paralelo giratorio Tables à translation tournante Slide turning tables Drehbar Schiebetische

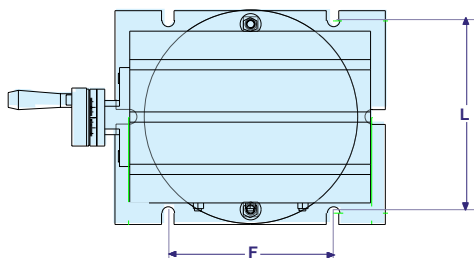
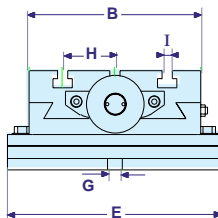
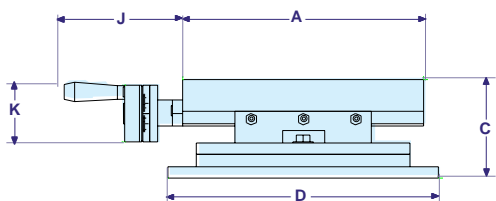

Mesas de coordenadas de un eje con base giratoria ( $\pm 90^\circ$ ). Esta serie de mesas es análoga a la serie MG, pero solamente con el movimiento de un eje



Tables à translation 1 axe avec base tournante ( $\pm 90^\circ$ ). Série analogue à la série MG, avec mouvement d'un axe seulement.









Rotating base single axis coordinate table ( $\pm 90^\circ$ ). This range of tables is similar to the MG series, but with only one axis movement

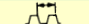

Drehbare Verschiebetische mit einer Achse ( $\pm 90^\circ$ ). Diese Serie entspricht der Serie MG, jedoch nur mit einer Achse.

MOD.	TP-0	TP-1	TP-2	TP-3	TP-4	
A	230	330	430	600	800	mm.
B	164	220	240	240	240	mm.
C	95	120	129	130	138	mm.
D	204	254	346	346	390	mm.
E	258	284	284	284	326	mm.
F		220	246	246	246	mm.
L		217	238	238	282	mm.
G	14	14	16	16	16	mm.
H	50	67	72	72	72	mm.
I	10	12	12	12	12	mm.
J	56	137	135	135	140	mm.
K	56	70	70	70	70	mm.
DIN 650 25 N°	3	3	3	3	3	

DATOS TECNICOS	TP-0	TP-1	TP-2	TP-3	TP-4	
Recorrido Longitudinal / X-Travel 	100	162	250	400	500	mm.
Resolución 	0,05	0,05	0,05	0,05	0,05	mm.
Paso rosca 	2	4	4	4	4	mm.
Peso neto / Poids net / Net Weight / Nettogewicht	20	36	43	53	120	kg.
Peso bruto / Poids brut / Gross Weight / Bruttogewicht	24	41	49	63	132	kg.
Máximo peso admitido en el centro de la mesa Poids maximum admis au centre de la table Maximum weight permitted for the centre of the table Höchstzulässiges Gewicht im Tischzentrum 	56	100	180	180	220	kg.
Máxima presión de trabajo en el centro de la mesa Pression de travail maximum au centre de la table Maximum working pressure for the centre of the table Höchstzulässiger Arbeitsdruck im Tischzentrum 	400	500	700	700	900	kg.
Dimensiones del embalaje Cubical measure of packing Volume de l'emballage Verpackungsmasse 	0,0182	0,0322	0,0432	0,0554	0,0720	m <sup>3</sup>